

EXAMPLE OF A CLEANROOM WORK AREA

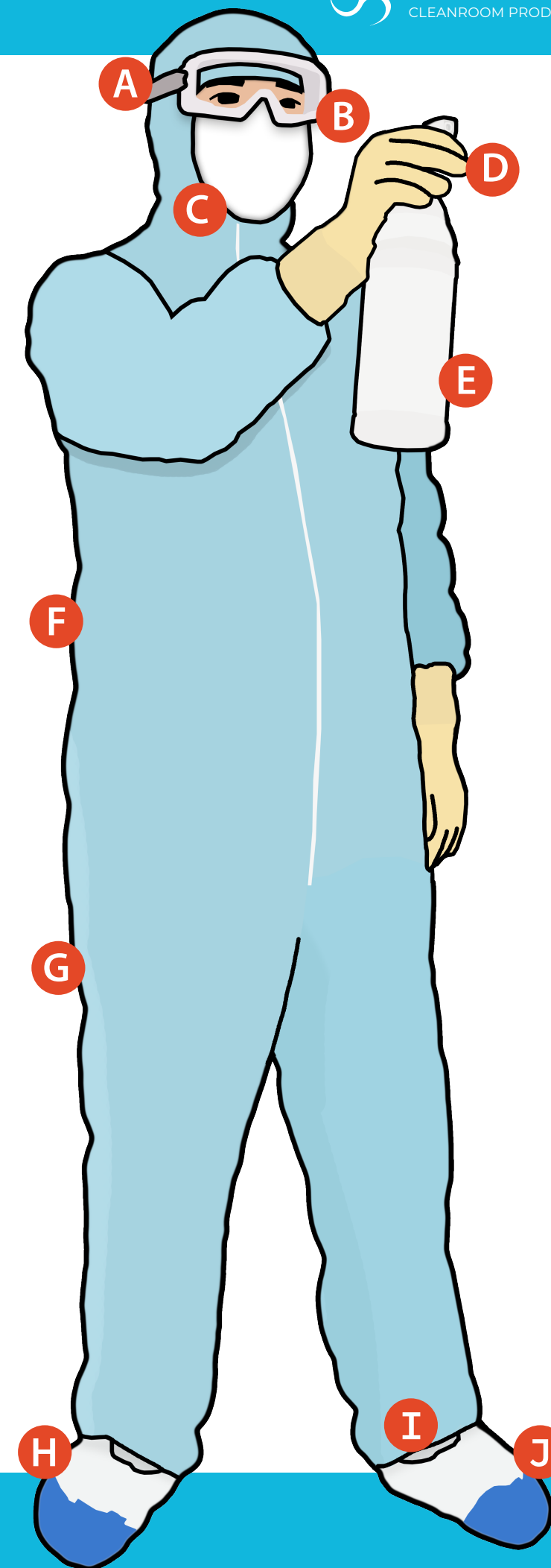
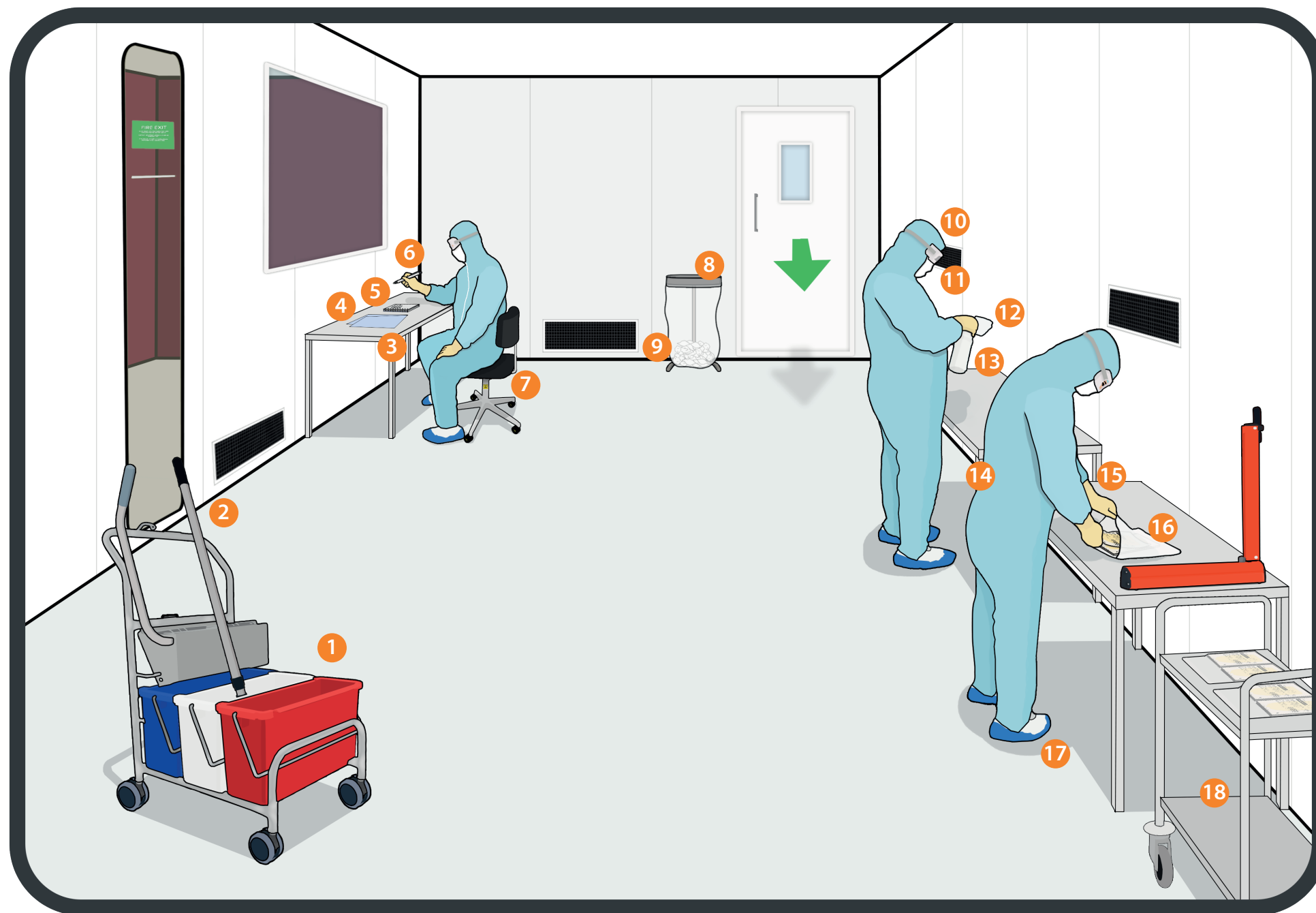

PRODUCTS

- | | | | | | |
|------------------------|-------------------------|------------------------|------------------------|-------------------|-----------------------------|
| 1. Mopping System | 2. Mop | 3. Cleanroom Workbench | 4. Autoclaveable Paper | 5. Lined Notebook | 6. Cleanroom Pen |
| 7. Ergonomic Chair | 8. Waste Sack Holder | 9. Refuse Sack | 10. Goggles | 11. Face Mask | 12. Wipe |
| 13. Disinfectant Spray | 14. Disposable Coverall | 15. Cleanroom Gloves | 16. LDPE Bags | 17. Shoe Covers | 18. Stainless Steel Trolley |

ANNEX 1 Regulations Effective August 2023

- | | | | | |
|---------------------------|--------------------------------|----------------------------|---------------------------------|------------------------------|
| A. Headwear
GMP 7.13ii | B. Goggles
GMP 7.13i & 7.14 | C. Face Masks
GMP 7.13i | D. Gloves
GMP 7.13i & 7.13iv | E. Disinfectants
GMP 4.33 |
| F. Garments
GMP 7.11 | G. Undergarments
GMP 7.13i | H. Socks
GMP 7.14 | I. Overshoes
GMP 7.13ii | J. Shoes
GMP 7.13ii |